



3rd Asia & South Pacific
BOCCIA
Championships 2009
HONG KONG
14 - 22 August

Championships Guide



香港賽馬會慈善信託基金
The Hong Kong Jockey Club Charities Trust



access to sport



民政事務局
(藝術及體育發展基金)
Home Affairs Bureau
(Arts and Sport Development Fund)



康樂及文化事務署
Leisure and Cultural
Services Department

Table of Contents

WELCOME MESSAGE	1
<u>GENERAL INFORMATION</u>	2-4
Competition Venue	2
Championships Secretariat Office	2
Official Hotel	2
Meals	3
Transportation	3
Social Programme	3
Prize Presentation	4
Classification	4
Team Manager Meetings	4
Medical Support	4
Wheelchair Repair	4
General Outline of the Competition	5-20
Key Personnel	5-7
Host Committee	5
Championships Secretariat	5
CPISRA Officials	6-7
Technical Delegate: Cannie Leung	6
Chief Classifier: Elsa Matthee	6
Head Referee: Paul Coffey	7
Assistant Head Referee: Pedro Fernandes	7
CHAMPIONSHIPS SCHEDULE	8
VENUE FLOOR PLAN	9
ACCREDITATION	10
CLASSIFICATION	10
SPORTS EQUIPMENT & SPORTS EQUIPMENT CHECK	11
THE COMPETITION	12-19
Entrants	12
Division of Play	12
Entries per Event	12
Team/Pairs Events	12-13
Competition Schedule and Technical Meetings	13
Competition Number	13
Competition Format	14-19
PRACTICE PRIOR TO COMPETITION & WARM UP	19
WARM-UP AREA PROCEDURES	19
CALL ROOM PROCEDURES	19
BOCCIA BALLS	20
PROTEST PROCEDURES	20
ANTI-DOPING CONTROL	20
APPENDIX	21-25

Welcome Message

On behalf of the Organizing Committee, I extend my warmest welcome to all athletes and officials for participating in the Championships. My special regards for those international technical officials who travel a long way from home to assist in organizing this important event.

The Hong Kong Paralympic Committee and Sports Association for the Physically Disabled is honoured to have the opportunity to host the 3rd Asia and South Pacific Boccia Championships 2009. We aim at facilitating an ideal platform for athletes to strike for their sport excellence. We also strive to extend the warmest hospitality to all participants during the Championships.

I wish you all have a pleasant and memorable stay in Hong Kong.

Martin Lam
Chairman, Organizing Committee

General Information

Competition Venue

All competitions will be held at the Main Hall of the Kowloon Park Sports Centre (22 Austin Road, Tsim Sha Tsui, Hong Kong)

Championships Secretariat Office

Official Hotel: 24/F Hyatt Regency Hong Kong, Shatin

Opening hours: 0800-2200 (14-15 August)

2000-2200 (16-20 August)

1400-1830 (21 August)

Competition Venue: Dance Room, Kowloon Park Sports Centre

Opening hours: 0800-1900 (15-20 August)

0800-1500 (21 August)

Official Hotel

Hyatt Regency Hong Kong, Shatin

Address: 18 Chak Cheung Street, Shatin, New Territories, Hong Kong

Telephone: (852) 3723-1234

Fax: (852) 3723-1235

Website : www.hongkong.shatin.hyatt.com

Participants will be responsible for any incidental charges such as pay- movie, laundry, mini bar, room internet connection (unless specify), room service and IDD calls etc. Request of late check-out time should be made to the Organizing Committee before **18 August**.

Meals

The Organizing Committee will be responsible for meals from **dinner of 14 August until breakfast of 22 August**. Meals coupons will be provided to the participants upon check-in. No replacement of coupons will be provided. Meals will only be redeemed with relevant meals coupons.

All breakfast and dinner will be taking place at the Official Hotel. Packed lunch will be served throughout the Championships period. Meal schedule and locations are listed below.

Breakfast	06:30-09:00	Shatin 18, 4/F, Official Hotel
Lunch	12:00-13:00	Press Room 2, Swimming Pool Area (Lunch Box Collection Only)
Dinner	19:00-21:00	Ballroom, Lobby level, Official Hotel (Except for 16/8 at Shatin 18)

Transportation

Shuttle service between the Official Hotel and Kowloon Park Sports Centre will be run throughout the Championships period. Timetable will be posted at the lobby of the Official Hotel. For the provisional transportation schedule, please refer to Appendix A.

Departure transfer to the airport or port of entry will be provided. Relevant departure form will be given to the participants prior to their departure.

University Station is the closest train station to the city and it is within walking distance from the Official Hotel. Teams who wish to have transportation for other purpose can contact the Liaison Officer designated for your team for rental arrangement.

Social Programme

The Gala Dinner will be held on Friday, 21 August at 1900 at the Ballroom of the Official Hotel. All participants are cordially invited. Dress code will be either team uniform or smart casual.

Hong Kong Disneyland Resort and Ocean Park have sponsored complimentary passes to all participants of the Championships. Due to limited numbers of passes allocated daily, registration must be made before **18 August** to the Liaison Officer designated for your team. First come first serve.

Prize Presentation

The top 3 ranks in the individual and team competitions will be presented with medals respectively. Medals presentation for individual events as well as Team and Pairs events will be held at the venue immediately after the Finals. The Hong Kong Jockey Club Outstanding Novice Awards (Overseas/Local) will be presented at the Gala Dinner.

Classification

Classification will take place on 14 and 15 August at Room 2318 of the Official Hotel. Participants who require classification are requested to bring along relevant document with them at the time arranged according to the classification schedule (Appendix B).

Team Managers' Meeting

Two Team Managers' Meeting will be held on 15 August at 1600 and 17 August at 2100 in the meeting room on the 26/F of the Official Hotel.

Medical Support

First aid service will be provided by the St. John Ambulance at the competition venue. Physiotherapy support will also be provided at the Press Room 1 of the swimming pool area. Teams are reminded to secure medical and accident insurance for their members before departure.

Wheelchair Repair

Wheelchair repair service will be available at the venue. The expenses of wheelchair parts will be at user own cost.

General Outline of the Competition

Classification at the 3rd Asia and South Pacific Boccia Championships 2009 (3rd ASP Champ.) shall run in accordance with the 9th Edition Cerebral Palsy International Sports and Recreation Association Manual.

Events of the 3rd ASP Champ. will run in accordance with the 10th Edition CPISRA International Boccia Rules

(http://cpisra.org/files/sports/boccia/Boccia_CPISRA_Rules_English_10th_Edition.pdf)

In case of doubt or disagreement in the interpretation of the rules, the English version shall prevail.

Any case not included in these documents shall be solved in accordance with the Technical Delegate of the competition.

It is the responsibility of each National Organization participating in 3rd ASP Champ. to ensure that all competitors and technical personnel are familiarized with these documents.

Key Personnel

The Organizing Committee

Chairman : Mr. LAM Martin
Members : Mr. CHUNG Wai Man
 Mr. NG Apollo
 Mr. NG Patrick

Championships Secretariat

Mr. CHAN Mark
Ms. CHOW Anyetty
Mr. LAM Glen
Mr. LEUNG Ricky
Ms. LIU Sheena
Mr. POON Bayon
Mr. TAM Jonathan
Ms. TSE Maggie
Ms. YEUNG Sandra

CPISRA Officials

Technical Delegate: LEUNG Cannie

- Supervise the organization of the competition so that it runs in accordance with all agreements made in prior meetings and CBC rules.
- Attend meetings prior to and during the competition.
- Verify that all facilities for training and competition meet the CBC regulations.
- Approve all material to be used during the event.
- Preside over the Appeals Committee.
- Witness and approve all draws, as well as the competition systems/programmes.
- Supervise the results.
- Assist the head referee and assistant head referee with all technical questions.

Chief Classifier: MATTHEE Elsa

- Classification schedule.
- Receive classification protests.
- Assigning of classification observations.

Chief Classifier	Ms. MATTHEE Elsa	South Africa
Classifier	Dr. BANG Moon Suk	Korea
	Ms. JENKINSON Kerry	New Zealand
	Dr. LAM James	Hong Kong
	Mr. MOHEBBI Behrouz Barjasteh	Iran
	Mr. SOKHANGUEI Yahya	Iran
Classifier in Training	Dr. LAM Kwong Chin	Hong Kong
	Mr. LIU Chi Hang	Hong Kong
	Dr. SHIEH Jeng-Yi, Vivian	Chinese Taipei

Head Referee: COFFEY Paul

Assistant Head Referee: FERNANDES Pedro

- Attend meetings called prior to and during the competition.
- Ensure courts and all equipment, including but not limited to balls, wheelchairs, assistive devices (including accessories such as head pointers) meet CBC regulations.
- Schedule referees.
- Work with the volunteer coordinators to schedule minor officials.
- Supervise the Call Room and random ball checks.
- Participate in and select referees for protest committees.
- Check, verify and sign all scoresheets.

Head Referee	Mr. COFFEY Paul	New Zealand
Assistant Head Referee	Mr. FERNANDES Pedro	Portugal
International Referee	Mr. BRUNT Harvey	New Zealand
	Ms. KAN Wai Chun, Grace	Hong Kong
	Ms. KO Yung Ching, Evelyn	Hong Kong
	Ms. LEE Hae Jeong	Korea
	Mr. LEUNG Man Yuk, David	Hong Kong
	Ms. MAH Yuk Han, Rosa	Hong Kong
	Ms. THURASINGAM Jayanayagee	Malaysia
	Ms. TSANG Po Lin, Pauline	Hong Kong
	Mr. WONG Foo Leong	Malaysia
National Referee	Ms. AU YEUNG Pui Yan, Jacqueline	Hong Kong
	Mr. NG Chi Ming	Hong Kong
	Ms. SHUM Wai Kiu, Vicky	Hong Kong
Linesperson	Ms. CHAN Pui Fong	Hong Kong
	Mr. CHAN Ying Yeung	Hong Kong
	Ms. CHEUNG Sau Ping	Hong Kong
	Ms. FAN Yee Sau	Hong Kong
	Ms. KWONG Daphne	Hong Kong
	Ms. LEE Ning San	Hong Kong
	Ms. LEUNG Tsz Ching	Hong Kong
	Mr. SUEN Chi Shing	Hong Kong
	Mr. SUNG Man Kit	Hong Kong
	Ms. TAM Kit Bing	Hong Kong
	Ms. TO Kit Sum	Hong Kong
	Ms. WONG Shui Fong	Hong Kong
	Ms. WU Yin Yung	Hong Kong

Championships Schedule

	14 th Fri	15 th Sat	16 th Sun	17 th Mon	18 th Tue	19 th Wed	20 th Thu	21 st Fri	22 nd Sat
Arrival/ Accreditation	★								
Equipment Check	★	★							
Classification	★	★							
Training	★	★							
Team Managers' Meeting		★		★					
Individual Competition			★	★	★	★			
Pairs/ Team Competition						★	★	★	
Prize Presentation Ceremony						★		★	
Gala Dinner								★	
Departure									★

Floor Plan

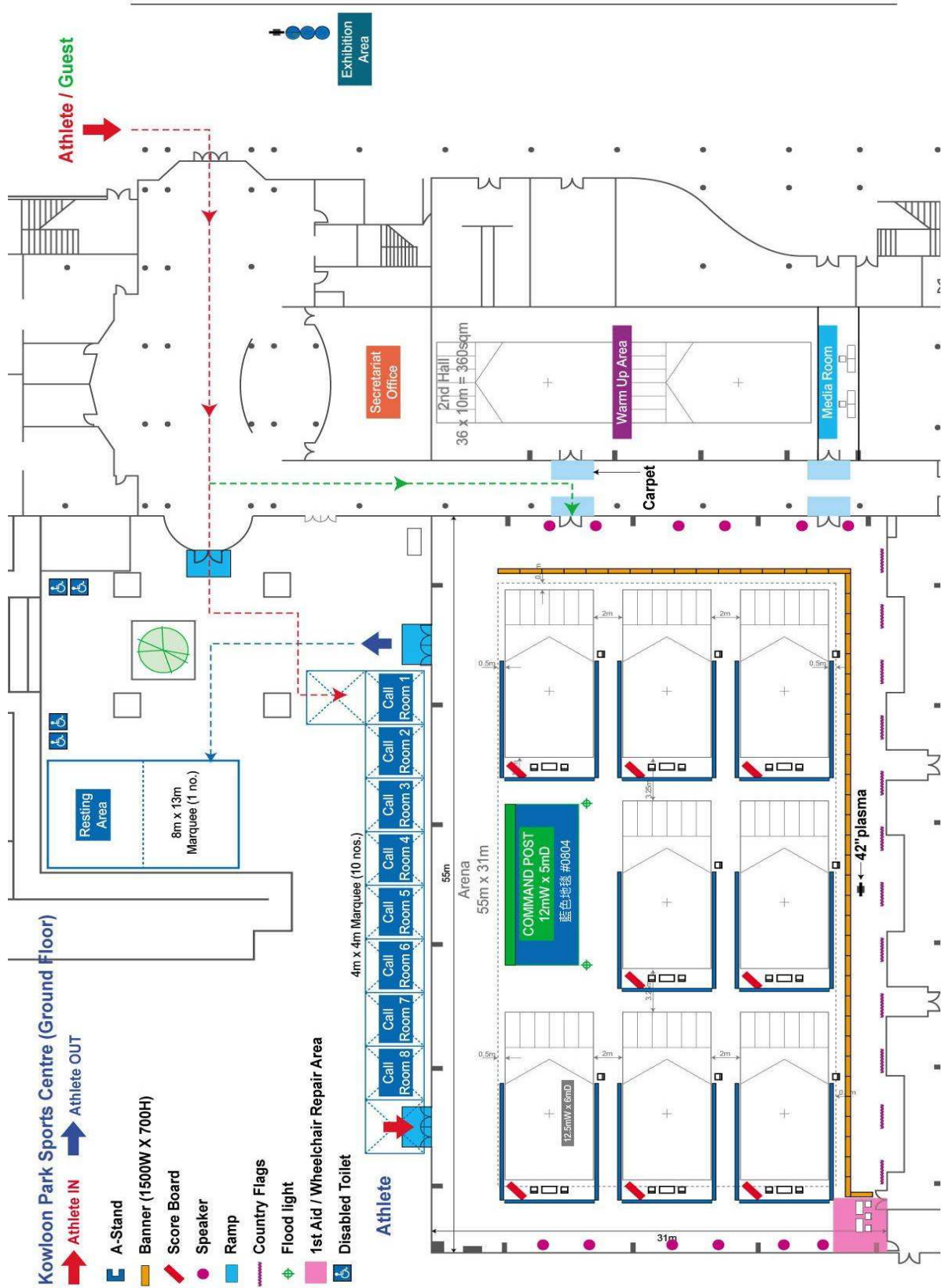

Scale 1:250 @ A3 size

Accreditation

All participants will receive accreditation upon arrival.

Classification

The Chief Classifier for the competition is the Head of Classification of CPISRA Boccia Committee, MATTHEE Elsa. The Classification Schedule can be found in APPENDIX B.

1. Athletes must come for classification at the schedule time with the following items.
 - The appropriate equipment to include chutes/ramps, boccia ball holders, head pointers, wheelchairs, splints and any other piece of equipment they use during competition.
 - Passport or ID Card
 - List of medications
 - Information on their disability

2. One person may accompany athletes from their national federation. A translator may also accompany the athlete if approved by the Chief Classifier.

Classification Protest Form

Available at the Classification Room and the Secretariat Office.

Sports Equipment & Sports Equipment Check

Athletes may use their own Sports Equipment. Sports Equipment includes:

- Balls
- Wheelchairs
- Assistive devices
- Head pointers

Prior to the competition commencing, from 14th to the morning of 15th, Sports Equipment will be checked by the referees team led by the Head Referee / Assistant Head Referee. The Equipment Check will be done in the Venue when countries come for their training sessions (Appendix C).

Equipment that meets the criteria as outlined in the 10th Edition CPISRA International Boccia Rules, will be approved and signed by the Head Referee / Assistant Head Referee (balls will not be signed, but subject to random checking inside Call Room). Equipment not meeting the criteria will not be approved.

At any time, except during a match, the referee may confirm the eligibility of any piece of equipment. Any equipment that fails eligibility during competition shall be confiscated for the remainder of the competition; details of this offence will be published at the Secretariat Office.

The Competition

The countries eligible to compete in the 3rd ASP Champ. are those who have paid all entry fees in full, submitted all required registration information and are current paid members of CPISRA.

A full list of participating athletes will be provided to Team Managers at the end of the 1st Team Managers' Meeting held on 15 August,

Entrants

Competitors must be 15 years of age or older by the first day of the year 2009.

Division of Play

Individual BC1, BC2, BC3, BC4 and Pairs BC3, Pairs BC4 and BC1/BC2 Teams.

Entries per Event

The maximum number of athletes per country in any individual event (BC1, BC2, BC3, BC4) is three (3).

The maximum number of athletes per

BC1/BC2 Team:	5
BC3 Pairs	: 3
BC4 Pairs	: 3

Team/Pairs Events

Each country must declare their Team and Pair athletes who shall compete in the Team and Pairs events not later than 17 August noon. Teams and Pairs must be in accordance with Rules 4.6, 4.7 and 4.8 of the CPISRA 10th Edition International Boccia Rules.

Rule 4.6 Pairs BC3

...A Pair BC3 must include a substitute. Exceptions will be at discretion of the CBC whose decision will be final. A Pair BC3 must include at least one CP Player on court.

For this competition, a BC3 pair can consist of 2 competitors classified as eligible to play in the individual BC3 division, but at least 1 of them must be a CP Player.

Rule 4.7 Pairs BC4

...A Pair BC4 must include a substitute.

For this competition, a BC4 pair can consist of 2 competitors classified as eligible to play in the individual BC4 division.

Competition Schedule and Team Managers' Meetings

The final competition schedule for individuals will be made available after the Official Draw at the 1st Team Managers' Meeting held on 15 August in the meeting room on the 26/F of the Official Hotel.

The Official Draw for the Team/Pairs Events will take place at the 2nd Team Managers' Meeting to be held on 17 August in the meeting room on the 26/F of the Official Hotel.

Competitor Numbers

Upon confirmation of classification, each athlete shall be given two (2) pieces of competitor number bibs that must be worn at all times during the hours of competition. One competitor number must be affixed on the front of the shirt or the trouser leg. The second competitor number must be affixed to the back of the wheelchair.

If an athlete forgets, loses or chooses not to wear their competitor number, they will not be permitted to enter the warm-up area, the Call Room or the field of play. A side that is not present for the start of the match forfeits the match (ref. 10.4.8). Exceptions may be considered by the Head Referee and/or the Technical Delegate.

Competition Format

According to rules of CBC, Boccia competitions are to be organized on a two-part basis: a preliminary stage of pool rounds, followed by Finals Stage of Single Elimination Round where Sides progress or are eliminated (knock-out). Pool Rounds are based on pools of 4-7 sides which all play each other once ("Round Robin" style format), with an agreed number of sides progressing to the Elimination Round.

The only exception to the above two-stage competition is where there are less than 8 entries for a division. In this situation, all sides will be in 1 pool, and only the pool round will be played with the positions of the sides after the completion of the pool being the final positions for the competition.

The numbers of entries for each division of play for the 3rd ASP Championships, as on 30 July, are as follows:

Division	Number of Entries
Individual BC1	22
Individual BC2	27
Individual BC3	23
Individual BC4	11
BC3 Pairs	9
BC4 Pairs	4
BC1/BC2 Teams	12

Hence, with the exception of BC4 Pairs which only have 4 entries, competitions would be organized on the above mentioned two-part basis, with pools of 4-6 sides. (BC4 Pairs would only play “pool rounds”.)

Choice of Pool Number and Pool Size

Copied below are the print-outs from a trial run of the competition program for the combinations of pools according to the above entries numbers, with the choice of pool number and total KO (knock-out) entry listed.

The elimination ratio of 40% to 70% is observed. The exception is the BC1/BC2 Teams which have 12 entries: an elimination ratio of 33.33% would be adopted (it would be less stressful for countries as in case only 4 knock-out advancers allowed). However, in case the number of entries for Teams is less than 12, for example, only 11 Teams after classification, there would only be $\frac{1}{4}$ -Finals.

In view of the time constraints, the maximum number of pools (based on the criterion of no less than 4 sides in each pool) would be chosen (highlighted in the corresponding print-outs).

Individual BC1 (Entry Number: 22)

pool number	pool direct KO	total direct KO	point qualifier	total KO entry	eliminate ratio	minimal pool size	pool match number
<input type="radio"/> 4	2	8	0	8	63.64%	5	50
<input checked="" type="radio"/> 5	1	5	3	8	63.64%	4	38
<input type="radio"/> 6	1	6	2	8	63.64%	3	30
<input type="radio"/> 7	1	7	1	8	63.64%	3	24

5 pools (3 pools of 4, 2 pools of 5), with the top-placed Sides from each pool (5 altogether) and 3 point-qualifiers (“best runner-ups) advancing to $1/8$ -Finals.

Individual BC2 (Entry Number: 27)

pool number	pool direct KO	total direct KO	point qualifier	total KO entry	eliminate ratio	minimal pool size	pool match number
<input type="radio"/> 5	2	10	6	16	40.74%	5	60
<input checked="" type="radio"/> 6	2	12	4	16	40.74%	4	48
<input type="radio"/> 7	2	14	2	16	40.74%	3	39
<input type="radio"/> 8	2	16	0	16	40.74%	3	33
<input type="radio"/> 9	1	9	7	16	40.74%	3	27

6 pools (3 pools of 4 and 3 pools of 5), with top two sides from each pool (12 altogether) and 4 point-qualifiers (“best runner-ups) advancing to $1/16$ -Finals.

Individual BC3 (Entry Number: 23)

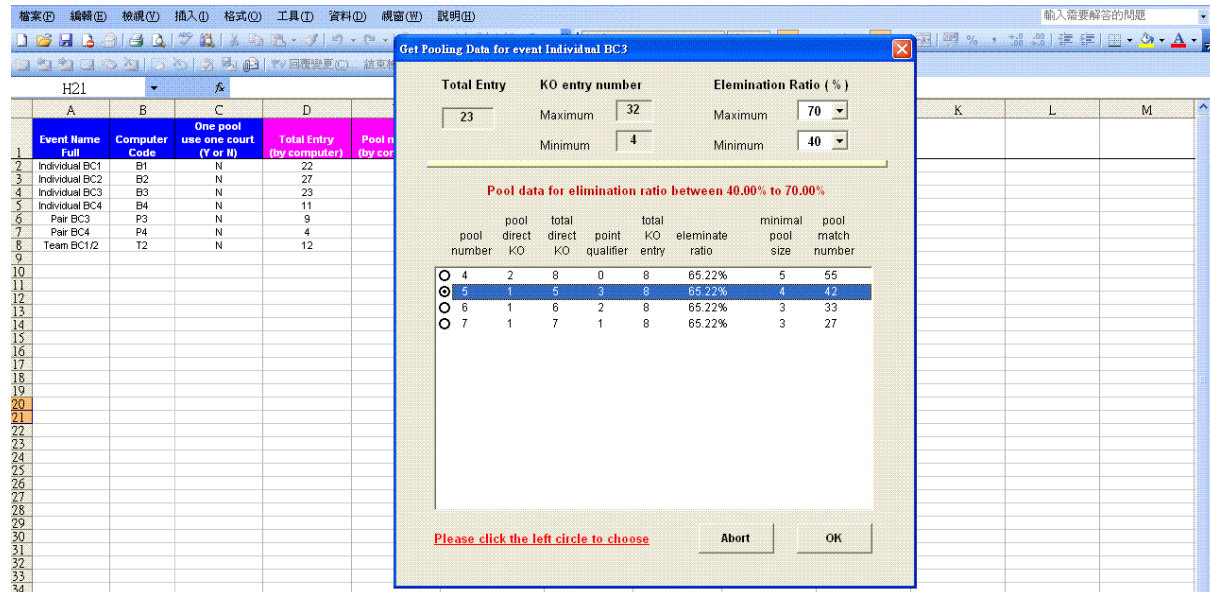

The dialog box shows the following configuration:

- Total Entry: 23
- KO entry number: Maximum 32, Minimum 4
- Elimination Ratio (%): Maximum 70, Minimum 40

Pool data for elimination ratio between 40.00% to 70.00%:

pool number	pool direct KO	total direct KO	point qualifier	total KO entry	eliminate ratio	minimal pool size	pool match number
<input type="radio"/> 4	2	8	0	8	65.22%	5	55
<input checked="" type="radio"/> 5	1	5	3	8	65.22%	4	42
<input type="radio"/> 6	1	6	2	8	65.22%	3	33
<input type="radio"/> 7	1	7	1	8	65.22%	3	27

Please click the left circle to choose

5 pools (2 pools of 4, 3 pools of 5), with the top-placed Sides from each pool (5 altogether) and 3 point-qualifiers ("best runner-ups) advancing to $1/8$ -Finals.

Individual BC4 (Entry Number: 11)

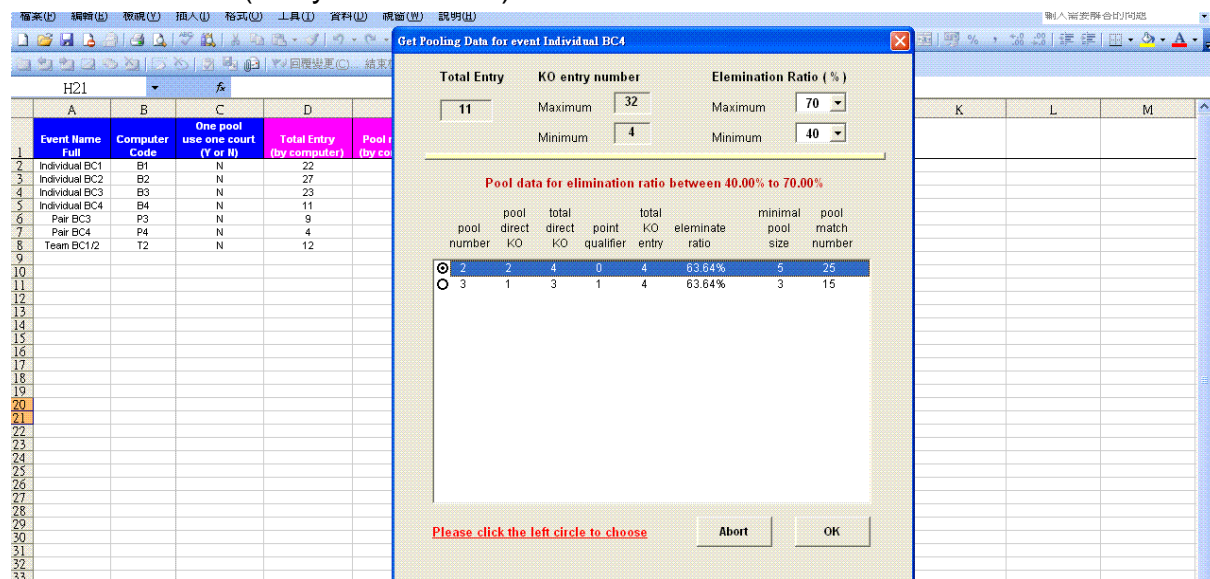

The dialog box shows the following configuration:

- Total Entry: 11
- KO entry number: Maximum 32, Minimum 4
- Elimination Ratio (%): Maximum 70, Minimum 40

Pool data for elimination ratio between 40.00% to 70.00%:

pool number	pool direct KO	total direct KO	point qualifier	total KO entry	eliminate ratio	minimal pool size	pool match number
<input checked="" type="radio"/> 2	2	4	0	4	63.64%	5	25
<input type="radio"/> 3	1	3	1	4	63.64%	3	15

Please click the left circle to choose

2 pools (1 pool of 5, 1 pools of 6), with top two sides from each pool (4 altogether) advancing to $1/4$ -Finals.

BC3 Pairs (Entry Number: 9)

pool number	pool direct KO	total direct KO	point qualifier	total KO entry	eliminate ratio	minimal pool size	pool match number
2	2	4	0	4	55.56%	4	16
3	1	3	1	4	55.56%	3	9

2 pools (1 pool of 4, 1 pool of 5), with top two sides from each pool (4 altogether) advancing to $1/4$ -Finals.

BC1/BC2 Teams (Entry Number: 12)

pool number	pool direct KO	total direct KO	point qualifier	total KO entry	eliminate ratio	minimal pool size	pool match number
2	2	4	0	4	66.67%	6	30
3	1	3	1	4	66.67%	4	18
3	2	6	2	8	33.33%	4	18
4	1	4	0	4	66.67%	3	12
4	2	8	0	8	33.33%	3	12

3 pools of 4 each, with top two sides from each pool (6 altogether) and 2 point-qualifiers (“best runner-ups) advancing to $1/8$ -Finals.

The provisional competition schedule has thus been drafted according to the above combination of pools and matches to be played (see attached file [“Provisional_Schedule_090730.xls”](#)). (Appendix D)

Pool Constitution

The constitution of pools is based on the Boccia Official World Ranking List 2008 published on the CPISRA website:

http://www.cpisra.org/files/sports/boccia/Boccia_CPISRA_World_Ranking_List_2008.pdf.

Sides will be seeded according to World Ranking. Every Side with a current World Ranking shall be seeded and put in pools accordingly. Sides not on the world rankings will be placed in pools randomly through the Official Competition Draw at the Team Managers Technical Meetings.

For individual competitions, the Pool configuration must ensure that **no more than two athletes from the same country are in the same pool**. In case that a third athlete from the same country is drawn in the same Pool, this athlete shall be placed in the next available pool. The next seeded or draw will then be placed in the previous pool. For example, if that third athlete is the seed 15th, he or she would swap with the seed 16th. However, in case if that that third athlete is the last seed, he or she would swap with the one in previous pool as possible.

Determining the Final Position of sides within a Pool

The following criteria should be used to determine the position of sides in a pool once all the matches have been completed. If any sides are in an equal position after one criterion has been applied then the next criteria should be used until the sides have been separated into positions.

1st – Matches won (the number of matches won by each side, in descending order).

2nd – Point difference (the total number of points scored, minus the total number of points conceded, in descending order).

3rd – Point for (the total number of points scored in descending order).

4th – Tie-break end (the winner of an additional tie-break end).

The Team Managers will be informed of match start time for the tie-break end.

Progression From Pool Rounds to Elimination Rounds

Apart from the 1 or 2 direct advancers, there would be point-qualifiers from some of the pools progressing into elimination rounds, as elaborated above.

The following criteria are applied to determine the point-qualifiers. If any sides are in an equal position after one criterion has been applied then the next criteria should be used until the sides have been separated into positions.

1st – Average point difference (the total number of points scored, minus the total number of points conceded, divided by the number of matches played, in descending order; points obtained in tie-breaks will not be counted).

2nd – Average point for (the total number of points scored, divided by the number of matches played, in descending order; points obtained in tie-breaks will not be counted).

3rd – Tie-break end (the winner of the extra end). The Team Managers will be informed of match start time.

The winning Sides of Elimination matches progress to the next Elimination round, and losing Sides are eliminated from the competition. Those Sides that lose at the semi-final stage shall play for the Bronze Medal.

Practice Prior to Competition & Warm Up

For Training Schedule of 14 and 15 August, please refer to APPENDIX E

Warm Up Area Procedures

Please refer to the official CPISRA 10th Edition International Boccia Rules Section 19. Athletes may enter the Warm-Up Area 90 (ninety) minutes before their scheduled match.

Call Room Procedures

Please refer to the official CPISRA 10th Edition International Boccia Rules Section 20. A Side must be registered between thirty (30) and fifteen (15) minutes before the scheduled start time of any match. Registration is done at the Call Room Desk. Six sets of Competition Balls will be available in the Call Room for use by Sides with incomplete personal sets or no personal sets. The players are able to examine the Boccia Balls prior to the spinning of the coin.

Boccia Ball

The Organizing Committee will have 10 sets of Competition Balls available for both training and competition. Four sets shall be kept in the Warm-Up Area and the remaining six sets shall be kept in the Call Room. The set of electronic scale balance and measuring template would be placed immediately outside the entrance to the Call Room for Sides to check the eligibility of their balls before entry.

Protest Procedures

Technical Protest procedures will be as documented in the 10th edition CPISRA International Boccia Rules. Classification Protest Procedures will be as documented in the CPISRA Sports Manual 9th Edition. Protest Forms will be available from and should be returned to the Secretariat Office. The decision of all Protests shall be available at the Secretariat Office.

Anti-Doping Control

Number of Samples:	Four (4)
Testing Agency:	China Anti-Doping Agency Laboratory
Sample Collecting Agency:	Hong Kong Anti-Doping Committee, Member of WADA

Method of Selection:

1. 2 samples will be collected amongst the gold medalists of four (4) individual events on 19 August.
2. The remaining 2 samples will be collected amongst the gold medalists of Team and Pair events.
3. The individual event medalists who will undertake doping test will be drawn at 1300 at the venue on the day by the Chairman of the Organization Committee. The same will be applied to the Team and Pair event.
4. Since the semi-finals of BC 4 individual event will be held after 1300, a second draw will be held immediately after the semi- finals if BC 4 event was selected in the initial draw at 1300.

Results managements

Results after analysis of samples will be sent by China anti-Doping Agency Laboratory at CPISRA Anti Doping Committee and Results Management will be under the responsibility of CPISRA according to CPISRA Anti Doping Code.

3rd Asia & South Pacific Boccia Championships 2009
(14 – 22 Aug)

Transportation Schedule

Date	Time	Route
14/8	According to flight arrival time	HK Int'l Airport -> Official Hotel
15/8	According to Training Schedule	Official Hotel -> Venue -> Official Hotel
16/8	0730 – 1000	Official Hotel -> Venue
	1000 – 1600	Shuttle Bus: (Frequency at 1 hour) Official Hotel <-> Venue
	1630-2030	Venue -> Official Hotel
17-20/8	0700 – 1000	Official Hotel -> Venue
	1000 – 1600	Shuttle Bus: (Frequency at 1 hour) Official Hotel <-> Venue
	1630-2030	Venue -> Official Hotel
21/8	0700 – 1000	Official Hotel -> Venue
	1000 – 1200	Shuttle Bus: (Frequency at 1 hour) Official Hotel <-> Venue
	1330-1530	Venue -> Official Hotel
22/8	According to flight departure time	Official Hotel -> HK Int'l Airport Optional: Official Hotel -> Disneyland -> HK Int'l Airport

***Subject to change. Please refer to the bus schedule daily posted at the Hotel Lobby.**

3rd Asia & South Pacific Boccia Championships 2009
(14 – 22 Aug)

Classification Schedule

Classification schedule will be held at Hotel (Room 2318.)

COUNTRY	DATE	
	14 Aug 2009 (Friday)	15 Aug 2009 (Saturday)
Australia	11: 00 – 12:30 (5)	
China	20:00 – 21:30 (8)	
Chinese Taipei	16: 45 – 17: 30 (3)	
Hong Kong	17: 30 – 18: 30 (3)	
Japan		08:00 – 09:15 (5)
Korea	14: 30 – 16: 00 (6)	
Kuwait		11:30 – 12:30 (4)
Macau	16: 00 – 16: 45 (3)	
Malaysia		12:30 – 13:00 (1)
New Zealand	14: 00 – 14: 30 (1)	
Singapore		10:15 – 11:30 (3)
Thailand		09:15 – 10:15 (3)

*Number in brackets represents those require classification.

3rd Asia & South Pacific Boccia Championships 2009
(14 – 22 Aug)

Equipment Check Schedule

Equipment check will be held at Kowloon Park Sports Center.

COUNTRY (Nos. of athletes)	DATE	
	14 Aug 2009 (Friday)	15 Aug 2009 (Saturday)
Australia (8)	15:30 – 16:00	
China (9)	16:00 – 16:30	
Chinese Taipei (4)		13:30 – 14:00
Hong Kong (11)	13:30 – 14:00	
Japan (11)		15:30 – 16:00
Korea (8)		13:30 – 14:00
Kuwait (6)		18:00 – 18:30
Macau (5)		14:00 – 14:30
Malaysia (4)	15:30 – 16:00	
New Zealand (6)		12:00 – 12:30
Singapore (5)		16:00 – 16:30
Thailand (6)		15:00 – 15:30

date	time	Court 1	Court 2	Court 3	Court 4	Court 5	Court 6	Court 7	Court 8
8-16	10:00	B2 A-1-1	B2 A-1-2	B2 F-1-1	B2 F-1-2	B2 C-1-1	B2 C-1-2	B2 D-1-1	B2 D-1-2
8-16	11:00	B3 A-1-1	B3 A-1-2	B3 B-1-1	B3 B-1-2	B3 D-1-1	B3 D-1-2	B3 E-1-1	B3 E-1-2
8-16	12:15								
8-16	13:15	B1 A-1-1	B1 A-1-2	B1 B-1-1	B1 B-1-2	B1 C-1-1	B1 C-1-2	B1 E-1-1	B1 E-1-2
8-16	14:15	B2 F-2-1	B2 F-2-2	B2 C-2-1	B2 C-2-2	B2 D-2-1	B2 D-2-2	B2 B-1-1	B2 B-1-2
8-16	15:15	B3 C-1-1	B3 C-1-2	B3 A-2-1	B3 A-2-2	B3 B-2-1	B3 B-2-2	B3 D-2-1	B3 D-2-2
8-16	16:30	B2 E-1-1	B2 E-1-2	B1 E-2-1	B1 E-2-2	B1 D-1-1	B1 D-1-2	B1 B-2-1	B1 B-2-2
8-17	09:30	B2 C-3-1	B2 C-3-2	B2 D-3-1	B2 D-3-2	B2 A-2-1	B2 A-2-2	B2 F-3-1	B2 F-3-2
8-17	10:30	B3 B-3-1	B3 B-3-2	B3 D-3-1	B3 D-3-2	B3 C-2-1	B3 C-2-2	B3 A-3-1	B3 A-3-2
8-17	11:45	B1 E-3-1	B1 E-3-2	B2 B-2-1	B2 B-2-2	B1 B-3-1	B1 B-3-2	B2 E-2-1	B2 E-2-2
8-17	12:45								
8-17	13:45	B3 E-2-1	B3 E-2-2	B3 B-4-1	B3 B-4-2	B3 D-4-1	B3 D-4-2	B3 A-4-1	B3 A-4-2
8-17	15:00	B1 A-2-1	B1 A-2-2	B2 D-4-2	B2 D-4-1	B2 F-4-1	B2 C-4-1	B2 C-4-2	B2 F-4-2
8-17	16:00	B1 B-4-1	B1 B-4-2	B1 E-4-1	B4 A-1-1	B4 A-1-2	B4 B-1-3	B4 B-1-1	B4 B-1-2
8-17	17:00	B2 A-3-1	B2 A-3-2	B2 B-3-1	B2 B-3-2	B2 E-3-2	B2 E-3-1	B1 E-4-2	B1 C-2-1
8-17	18:00	B4 B-2-1	B4 B-2-2	B4 B-2-3	B4 A-2-1	B4 A-2-2	B1 D-2-1	B1 D-2-2	B1 C-2-2
8-18	09:30	B2 D-5-1	B2 D-5-2	B2 C-5-2	B2 F-5-1	B2 F-5-2	B2 C-5-1	B1 A-3-1	B1 A-3-2
8-18	10:30	B3 A-5-1	B3 A-5-2	B3 B-5-1	B3 B-5-2	B3 D-5-1	B3 D-5-2	B3 C-3-1	B3 C-3-2
8-18	11:45	B1 C-3-1	B1 C-3-2	B1 E-5-1	B4 B-3-3	B4 B-3-2	B4 B-3-1	B3 E-3-1	B3 E-3-2
8-18	12:45								
8-18	13:45	B4 A-3-1	B4 A-3-2	B4 B-4-2	B1 E-5-2	B1 B-5-2	B1 D-3-2	B1 D-3-1	B1 B-5-1
8-18	14:45	B2 ko16-1	B2 ko16-2	B2 ko16-3	B2 ko16-4	B2 ko16-5	B2 ko16-6	B2 ko16-7	B2 ko16-8
8-18	16:00	B1 ko8-1	B1 ko8-2	B1 ko8-3	B1 ko8-4	B3 ko8-1	B3 ko8-2	B3 ko8-3	B3 ko8-4
8-18	17:45	B2 ko8-1	B2 ko8-2	B2 ko8-3	B2 ko8-4	B4 A-4-1	B4 A-4-2	B4 B-4-3	B4 B-4-1
8-19	09:30	B1 ko4-1	B1 ko4-2	B2 ko4-2	B2 ko4-1	B3 ko4-1	B3 ko4-2	B4 A-5-1	B4 A-5-2
8-19	10:30				B4 B-5-1			B4 B-5-3	B4 B-5-2
8-19	11:20	B3 ko2-1	B3 ko2-2	B1 ko2-1	B1 ko2-2	B2 ko2-1	B2 ko2-2		
8-19	12:30							B4 ko4-1	B4 ko4-2
8-19	14:00	P3 B-1-1	P3 B-1-2	T2 A-1-1	T2 A-1-2	T2 B-1-1	T2 B-1-2	T2 C-1-1	T2 C-1-2
8-19	15:30			B4 ko2-1	B4 ko2-2	P3 A-1-1	P3 A-1-2		
8-19	17:00			P3 B-2-1	P3 B-2-2				
8-20	09:30	P3 B-3-1	P3 B-3-2	T2 A-2-1	T2 A-2-2	T2 B-2-1	T2 B-2-2	T2 C-2-1	T2 C-2-2
8-20	11:00			P3 A-2-1	P3 A-2-2				
8-20	12:30	T2 A-3-1	T2 A-3-2	T2 B-3-1	T2 B-3-2	T2 C-3-1	T2 C-3-2	P3 B-4-1	P3 B-4-2
8-20	14:00	P4 A-1-1	P4 A-1-2			P3 A-3-1	P3 A-3-2		
8-20	16:30	T2 ko8-1	T2 ko8-2	T2 ko8-3	T2 ko8-4			P3 B-5-1	P3 B-5-2
8-21	09:30	P3 ko4-1	P3 ko4-2	T2 ko4-1	T2 ko4-2	P4 A-2-1	P4 A-2-2		
8-21	12:30	P3 ko2-1	P3 ko2-2	T2 ko2-1	T2 ko2-2	P4 A-3-1	P4 A-3-2		

3rd Asia & South Pacific Boccia Championships 2009**14 – 22 August****Teams Training Schedule**

Training will be held at Kowloon Park Sports Centre.

COUNTRY (Nos. of athletes)	DATE	
	14 Aug 2009 (Friday)	15 Aug 2009 (Saturday)
Australia (8)	16:00 – 18:00, Court 4 – 5	10:00 – 12:00, Court 1 – 2
China (9)	14:00 – 16:00, Court 4 – 6	12:00 – 14:00, Court 1 – 2
Chinese Taipei (4)		10:00 – 12:00, Court 8 14:00 – 16:00, Court 1
Hong Kong (11)	14:00 – 16:00, Court 1 – 3	12:00 – 14:00, Court 5 – 6
Japan (11)	16:00 – 18:00, Court 6 – 8	16:00 – 18:00, Court 1 – 2
Korea (8)		10:00 – 12:00, Court 5 – 7 14:00 – 16:00, Court 2 – 4
Kuwait (6)		14:00 – 16:00, Court 7 – 8 16:00 – 18:00, Court 5 – 6
Macau (5)		12:00 – 14:00, Court 3 – 4 16:00 – 18:00, Court 8
Malaysia (4)	16:00 – 18:00, Court 3	16:00 – 18:00, Court 7
New Zealand (6)	10:00 – 12:00, Court 1 – 2	10:00 – 12:00, Court 3 – 4
Singapore (5)	16:00 – 18:00, Court 1 – 2	14:00 – 16:00, Court 5 – 6
Thailand (6)		12:00 – 14:00, Court 7 – 8 16:00 – 18:00, Court 3 – 4